

# ACRYLIC SERIES

## Installation Instructions Wall Mount

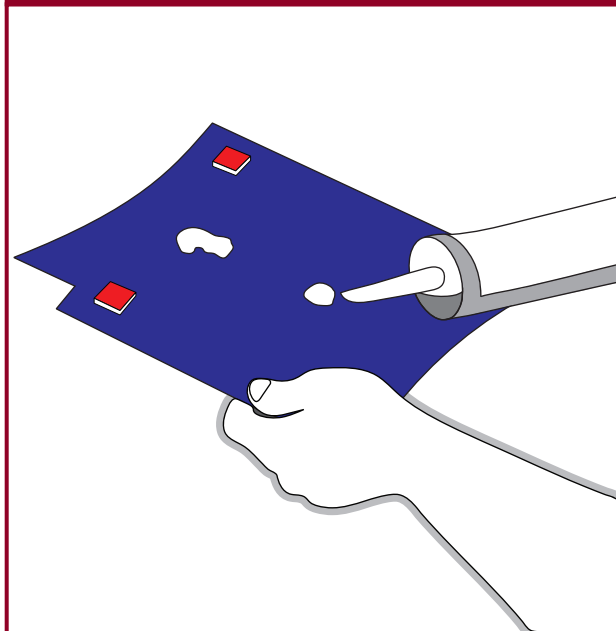

### STEP ONE: Silicone Adhesive



Apply a small amount of silicone adhesive to the back side of the sign.  
\*Silicone adhesive not included.

### STEP TWO: Peel

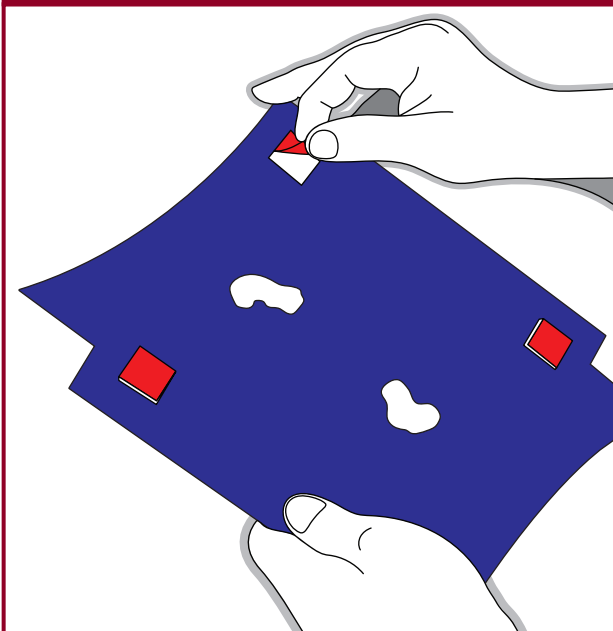

Remove backing from pre-positioned double-sided tape.

### STEP THREE: Level



Using a level, position sign on the wall in the desired location. Assure accurate ADA guideline placement.

### STEP FOUR: Mount



Apply pressure to secure sign to wall.