

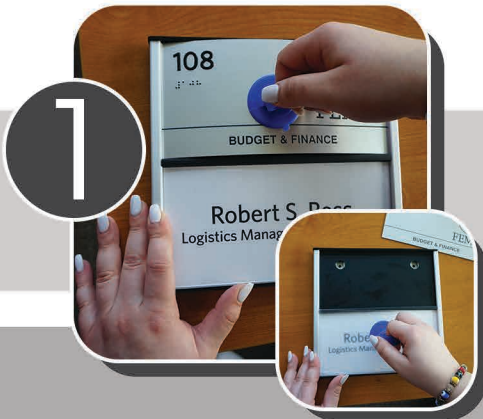

# Six Easy Installation Steps

INTERIOR SIGN SYSTEM



Using the provided suction cup, remove top and bottom lens and paper inserts, and set aside.

Position the sign on the wall. Using the visible mounting holes, mark the wall for the future drilling locations.

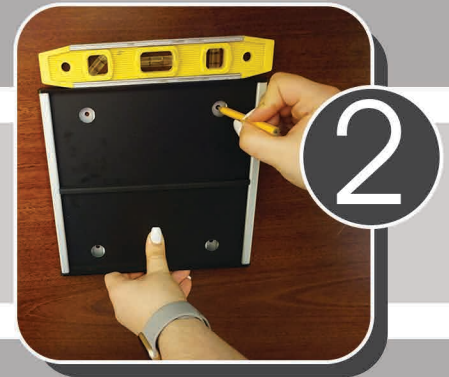

Utilizing the marks made, drill mounting holes into the wall and insert the appropriate anchors. (Anchors not included.)

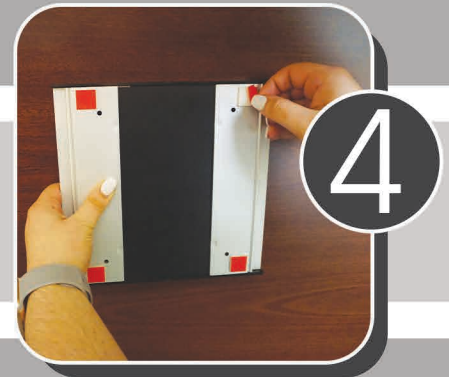

Remove paper from pre-positioned double-sided tape and temporarily fasten the sign to the wall for hardware insertion.



Permanently secure the sign to the wall using the appropriate hardware. (Hardware not included.) Your sign should be fully supported.



Place all inserts back into the frame that were removed in step 1. Be sure the clear lens has non-glare side face out.



## CONGRATULATIONS on your newly installed signage!