

TYP
 Dwg. No.:
 XXXX-XX

HED I-12 "Twin Hinge" Directory

Double Post, Single Face,
 Custom Painted Finish, Illuminated (120 Volt, 3.3 Amps)

Top View



Side A

84 5/8"
 76 3/4" VO

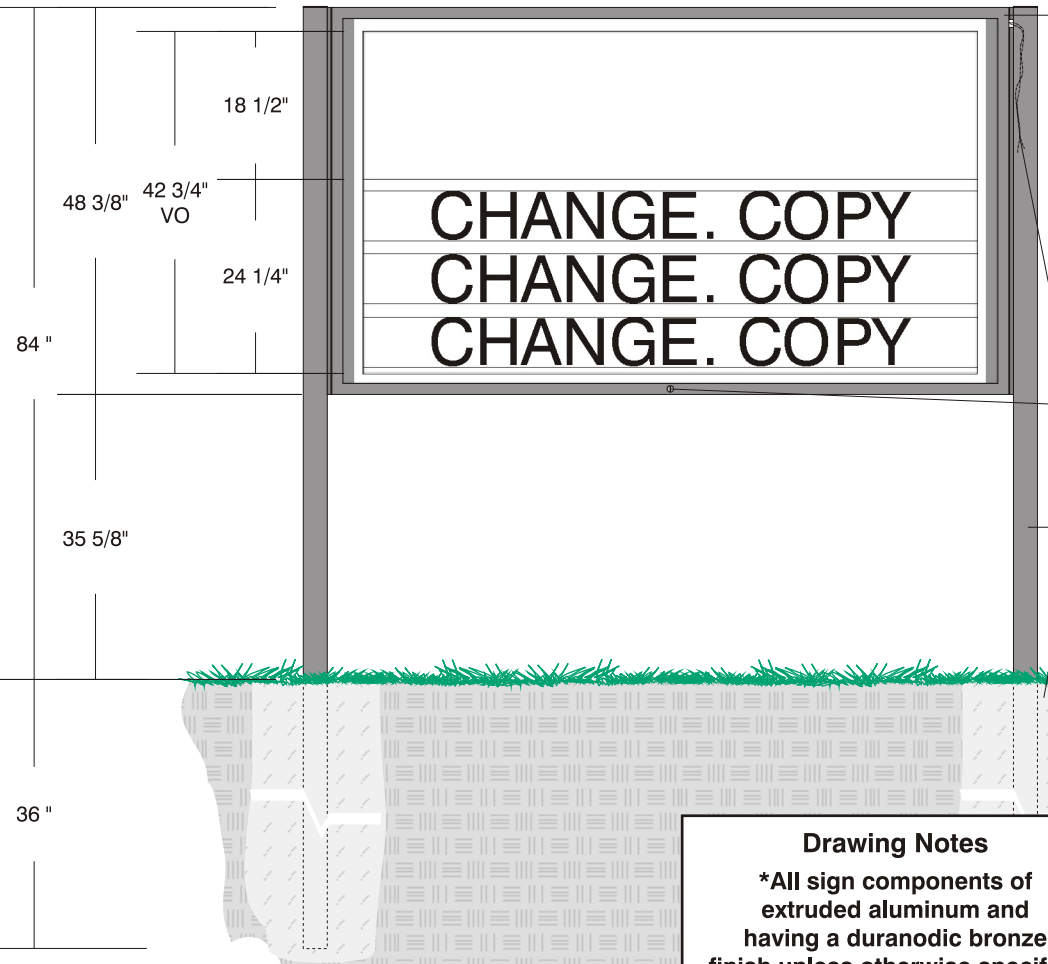

HED I-12 "Twin Hinge" illuminated sign system with
 *12" outer frame having (1) 48" x 84" x .125"
 clear polycarbonate front panel with 1 1/2"
 vinyl stripes concealing support arms and
 (1) 48" x 84" x .050" aluminum back panel
 *"Twin Hinge" inner frame painted White with
 (1) 44" x 78" x .125" white acrylic panel
 having 24 1/4" x 76 3/4" clear prono
 track for 3 rows of 6" changeable copy

Electrical hookup inside of post

(1) Key lock secures
 retainer to frame

(2) 3" x 7" x 120" mounting posts

Foundation by others

Side B Detail

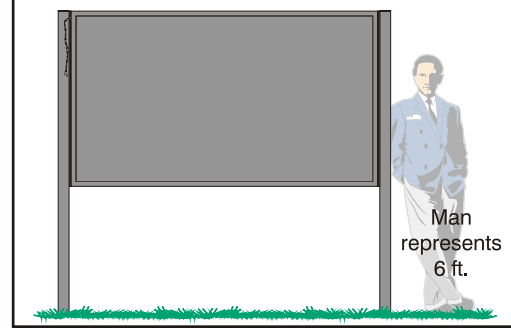

Side View

12"
 7"

Support arm with
 shock provides
 45 lbs. of lift and
 securely holds frame
 open for easy access
 to changeable copy

Custom HED I-12 "Twin Hinge" Detail

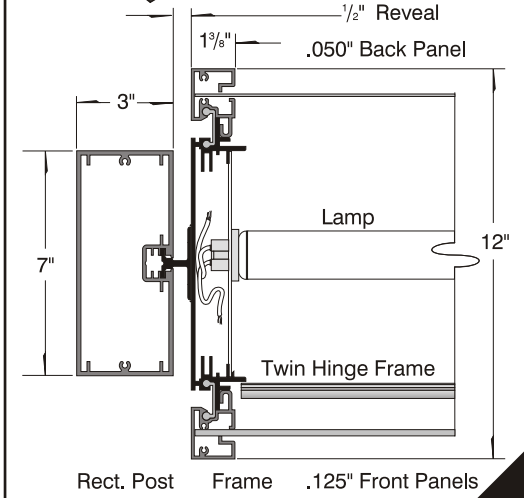
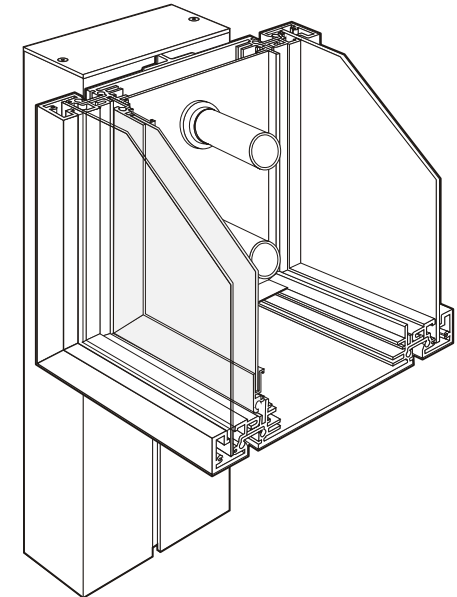

HED I-12 Twin Hinged Faces

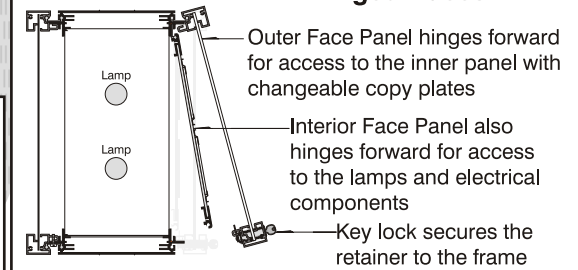

Drawing Notes
 *All sign components of
 extruded aluminum and
 having a duranodic bronze
 finish unless otherwise specified

Client: XXXX
 System: HED I-12
 Date: 01-05-05
 Scale: 1/2" = 1'-0"

X.X.
 Drawing format is
 faxed to fit legal
 size paper,
 8-1/2" x 14"

This drawing was specifically created for: XXXX
 Sales Representative: XXXX
 6400 Howard Drive, Fairview, PA 16415 • Toll Free 800/458-0591 • PA 814/833-7000 • Fax 814/838-0011

