

**Key Lock Installation Instructions**

The Key Lock assembly should be installed in bottom sign frame retainer and should be located lengthwise at the center of the sign.

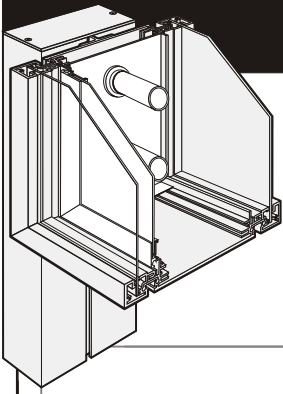

**Key Lock...Retainer Alterations**

**Step 1**

Installation for the Key Lock Assembly will require alterations to both the sign frame and the retainer. Suggested tools include Hacksaw, 3/4" Hole Saw, and Phillips Screw Driver.

Locate and mark the center point on the face of the bottom retainer. Locate the same center point on the lip of this retainer. At this center point cut away or notch out 1-3/8" of the lip of the retainer. Drill a 3/4" hole through the face of the retainer, continuing through the back wall of the extrusion.

**Retainer Alterations Step 1**

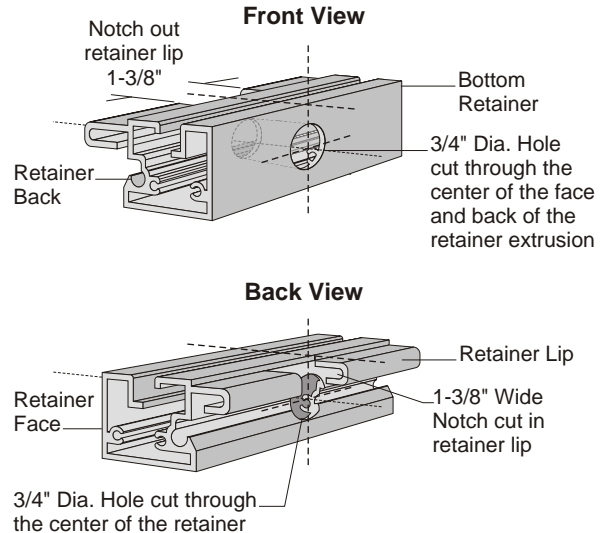

**Step 2**

When facing the back of the retainer, grind or cut away the underside of the retainer lip for 1-3/8" to the right of the notch cut away in Step 1.

**Alterations to the Underside of the Retainer Lip**

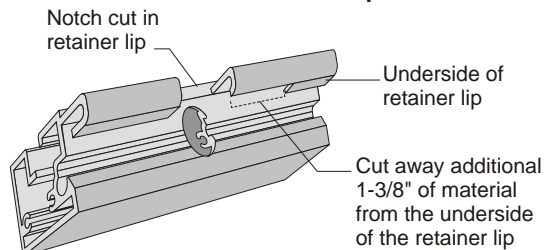

Continue with Frame Alterations on the back.

