

Assembly and Installation Instructions

Carefully select the location of your sign to be sure that it will be readily visible to those for which it is intended. Before installing any sign, be sure that the installation does not obstruct traffic or hamper local utilities, landscape, maintenance, snow-plowing, etc...

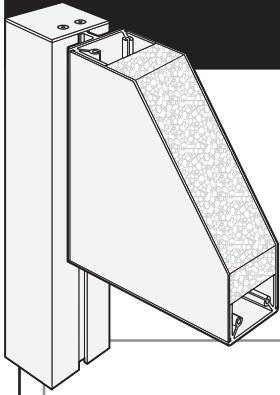

Double Post Mount

Step 1

Carefully unpack the posts and frame assembly from the shipping cartons. Laying the posts on the ground (use shipping cartons underneath to avoid damage), slide the frame assembly into the appropriate post slots from the bottom until the frame is flush to the post caps, which are attached prior to shipping. Slide the locking squares into the post slots flush to the bottom of the frame and tighten in position using an allen wrench.

Step 2

Laying the assembled sign on the ground as a guide, dig two 8" diameter x 30" deep holes; if the sign panel is 36" or higher, dig the holes 36" deep. Insert the sign posts into the holes and fill each hole with concrete. Level the sign both horizontally and vertically.

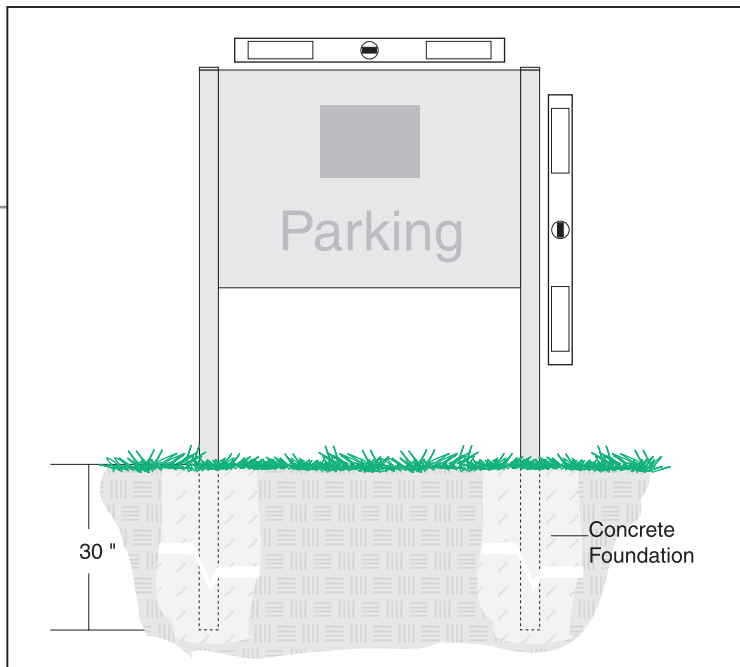
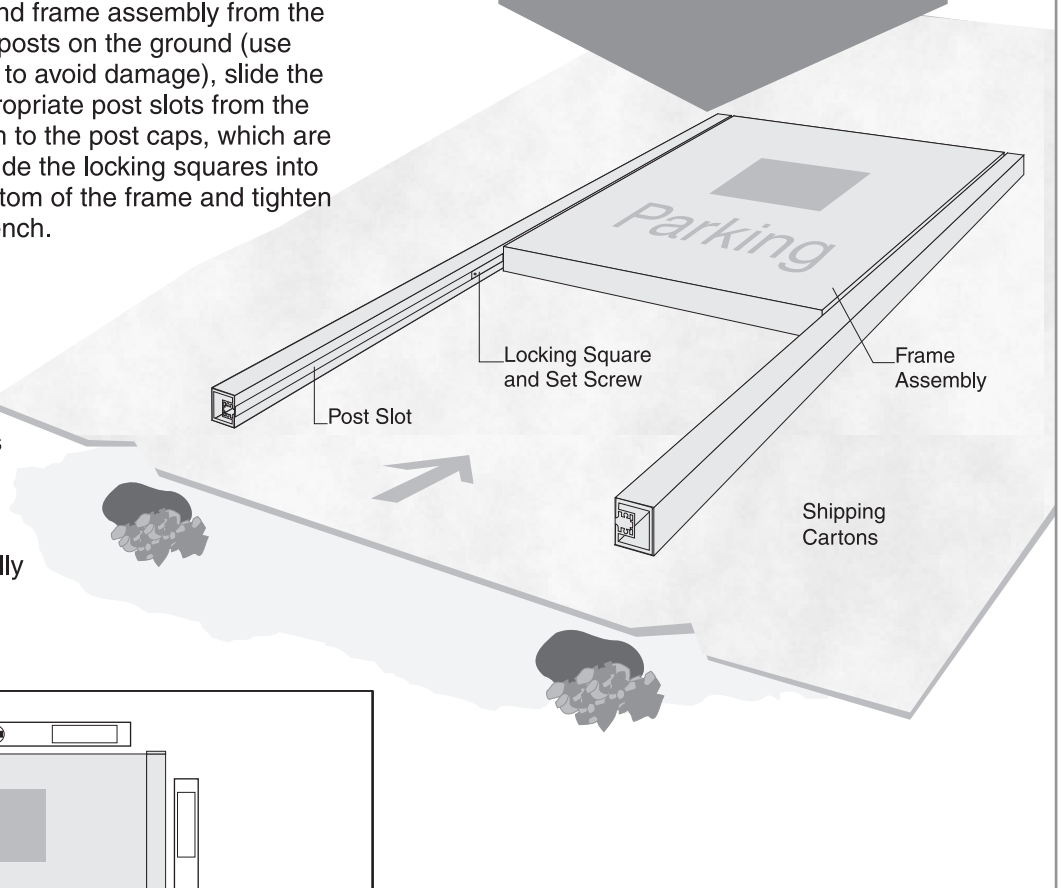
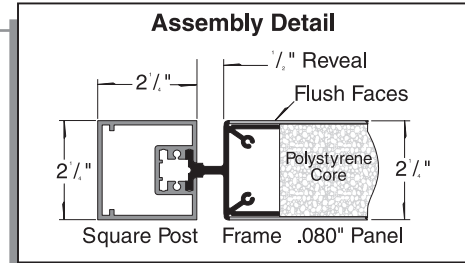

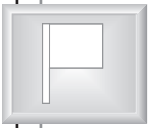

Flag Mount

Step 1

Carefully unpack the post from the shipping carton. Laying the post on the ground as a guide, (use the shipping carton underneath to avoid damage), dig a 8" diameter x 30" deep hole; if the sign panel is 36" or higher, dig the hole 36" deep. Insert the sign post into the hole, making sure the slot is in the correct position and fill the hole with concrete. Level the post both horizontally and vertically.

Step 2

Once the concrete is set, unpack the frame assembly and slide it into the appropriate post slot until the top of the frame is level with the top of the post. Using an allen wrench, tighten the set screw or locking square to secure the frame in the post. To complete the assembly attach the post cap to the top of the post using the two screws supplied.

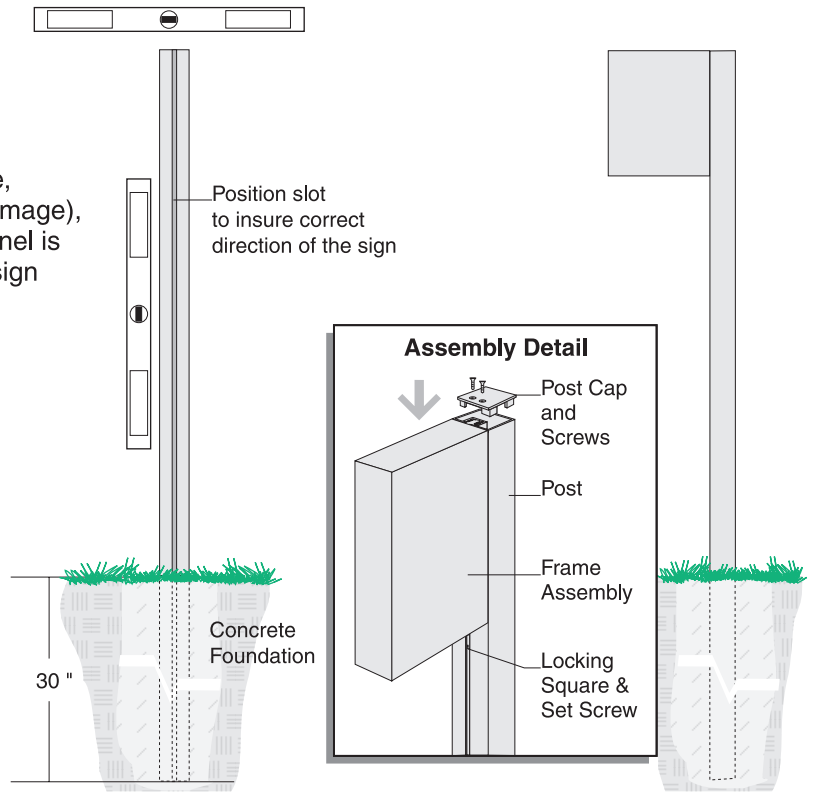

Wall Mount

Step 1

Carefully unpack the frame assembly and brackets from the shipping carton. Notice how the holes in the brackets align with the holes in the top and bottom frame extrusions. Align the brackets and temporarily attach to the sign frame with supplied fasteners. Locate the sign on the wall surface, be sure the sign is level and mark the placement of the brackets. Remove the brackets from the sign frame.

Step 2

Secure the brackets to the wall surface per your markings using appropriate fasteners, not supplied. Slide the sign frame between the brackets, aligning the holes in the brackets and the frame. Secure the frame with the supplied fasteners, removed in step 1, tighten into the threaded plate welded to the interior of the frame.

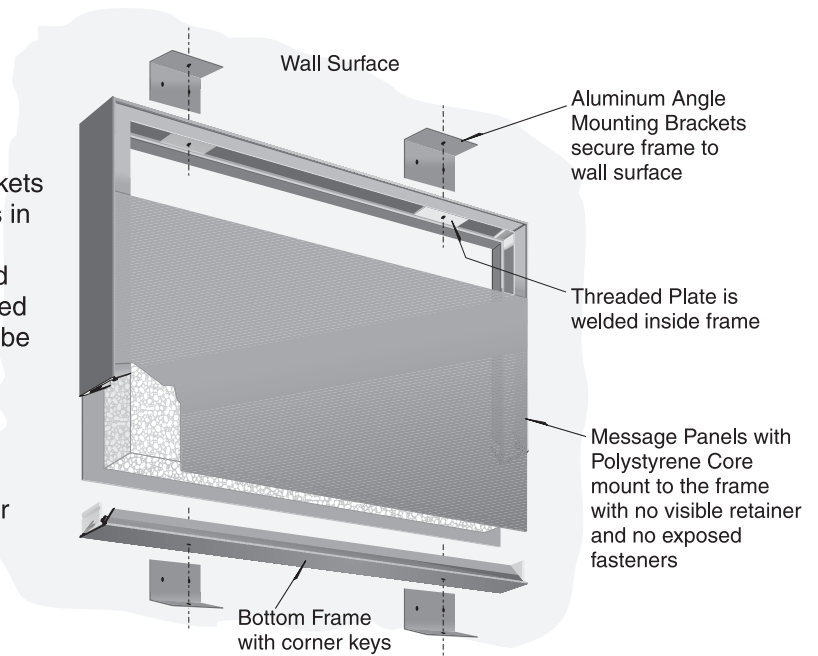

Signs ship completely assembled ready to be installed with the supplied angle brackets.

